

Crank Assemblies

TurboTrainer (9-4550-MINTP0)

Parts Required:

- Right Crank Arm Assembly
(PN: 718-5382-20)
- Left Crank Arm Assembly
(PN: 718-5383-20)

Tools Required:

- Screwdriver Set or Specific Drivers
 - Phillips Head Screwdriver
- Metric Hex Key Wrench Set or Specific Keys
 - 4mm Hex Key
 - 5mm Hex Key
- 22mm x 1.0 Pitch Crank Puller
- Torque Wrench

Instructions:

1. Remove the crank ring shroud (Fig. 1) from the left & right large base shrouds by extracting the lone phillips head screws that hold each ring in place and then turn each of the rings clock-wise to unlock and pull off.

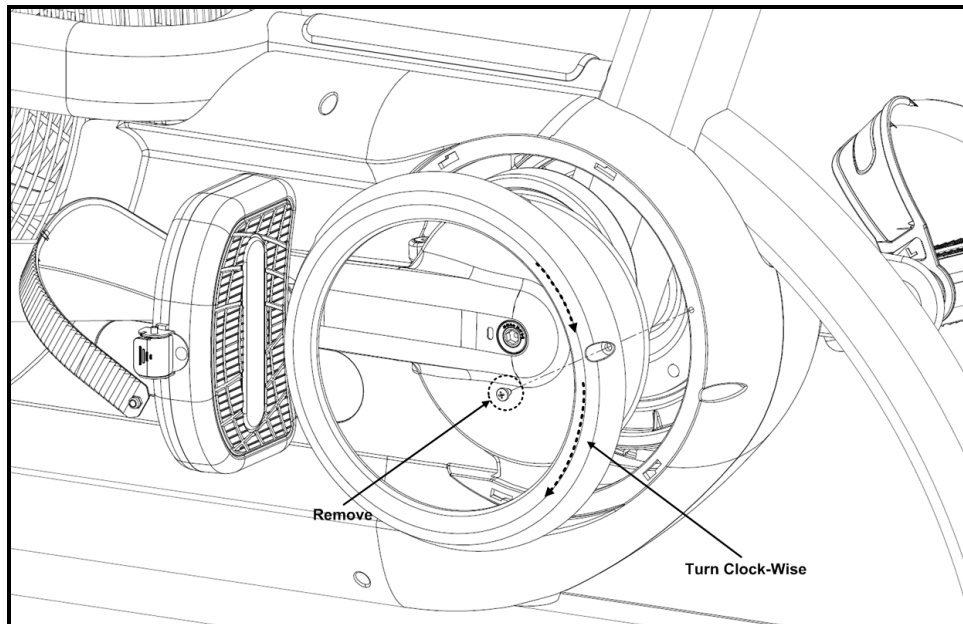

Fig. 1

2. Detach the left & right crank linkage arms from the crank cams by removing the two securing shoulder bolts (Fig. 2) from each crank cam using a 4mm hex key and pull the linkage arm away from the crank cam bracket.

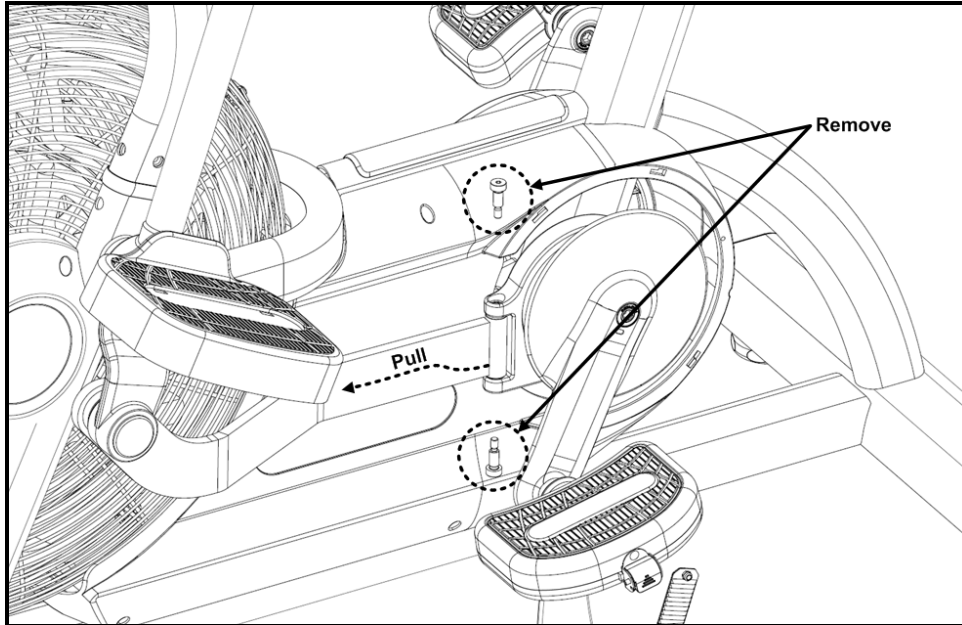

Fig. 2

3. Using a 5mm hex key; remove the left & right crank arm specialized socket head securing screw (Fig. 3) from the crank arms.

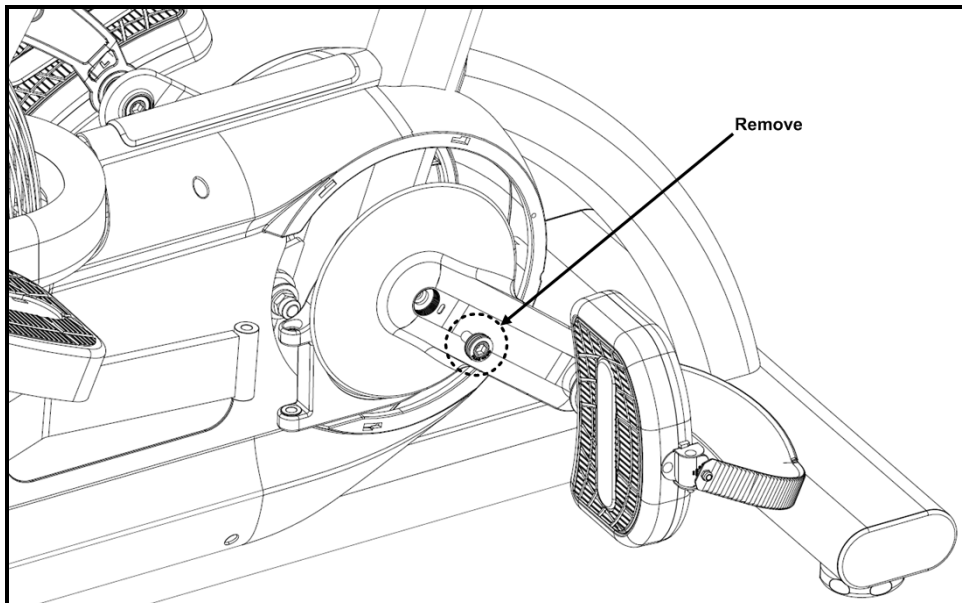

Fig. 3

4. Insert the crank removing tools base nut into each crank arm until the nut is fully seated in the female threaded crank bore (Fig. 4). Turn the crank puller's bolt in a clock-wise direction until each crank comes loose from the bottom bracket shaft.

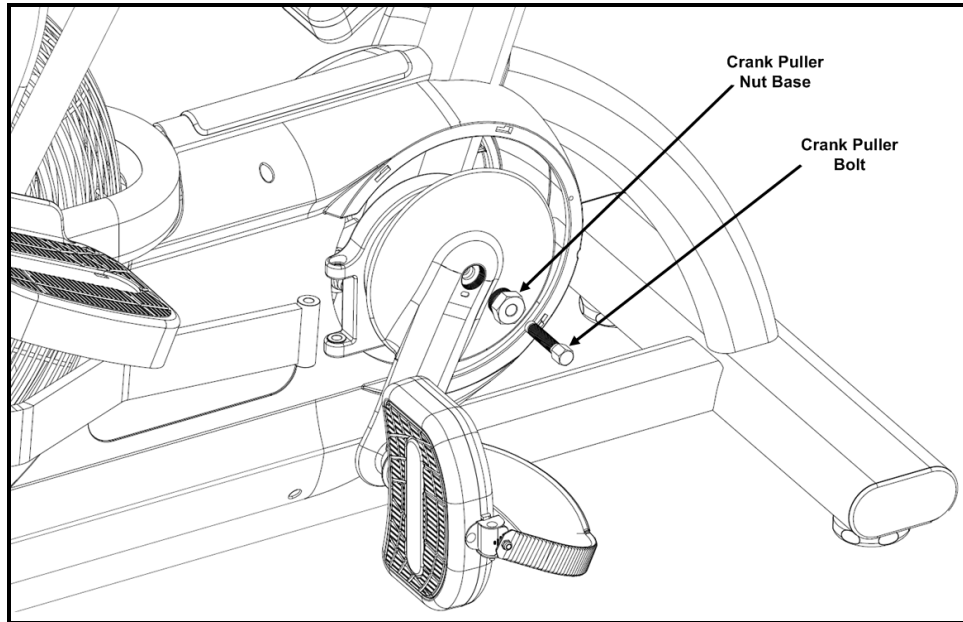

Fig. 4

5. Pull each crank arm assembly off the shaft verifying the clocking dowel pin (Fig. 5) is removed from the bottom bracket shaft.

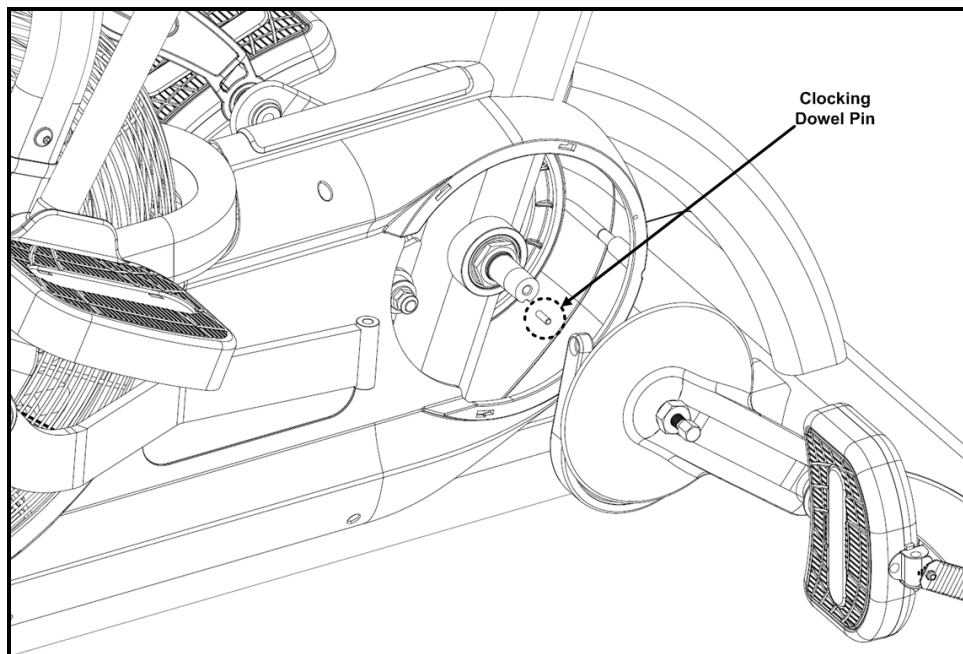

Fig. 5

- To reinstall the new crank arms, insert the clocking dowel pin (Fig. 6) into the groove that is machined into the new cranks female bore.

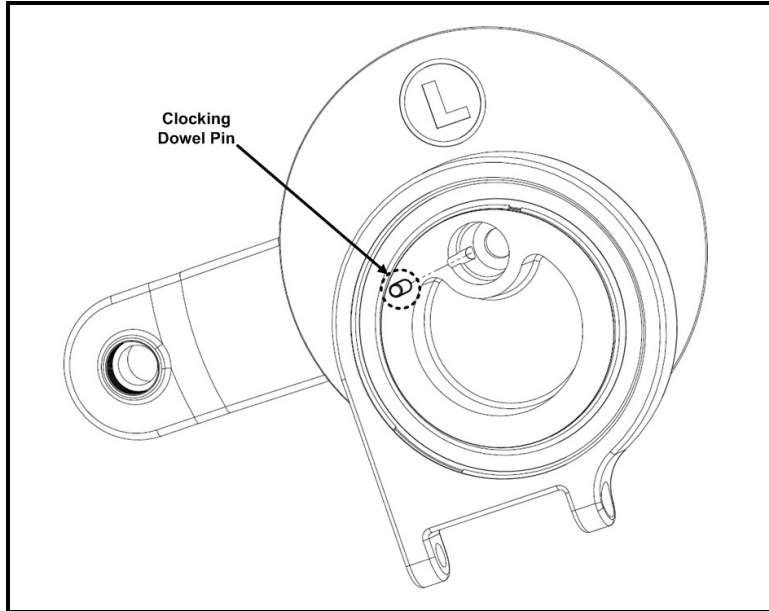

Fig. 6

- Mount the new crank assembly (Fig. 7) onto the bottom bracket shaft and insert the specialized securing socket head bolt through each crank arm and into the bottom bracket shaft.

Note:

Transfer the pedals from the old cranks at this point or install a new set of pedals onto each crank arm.

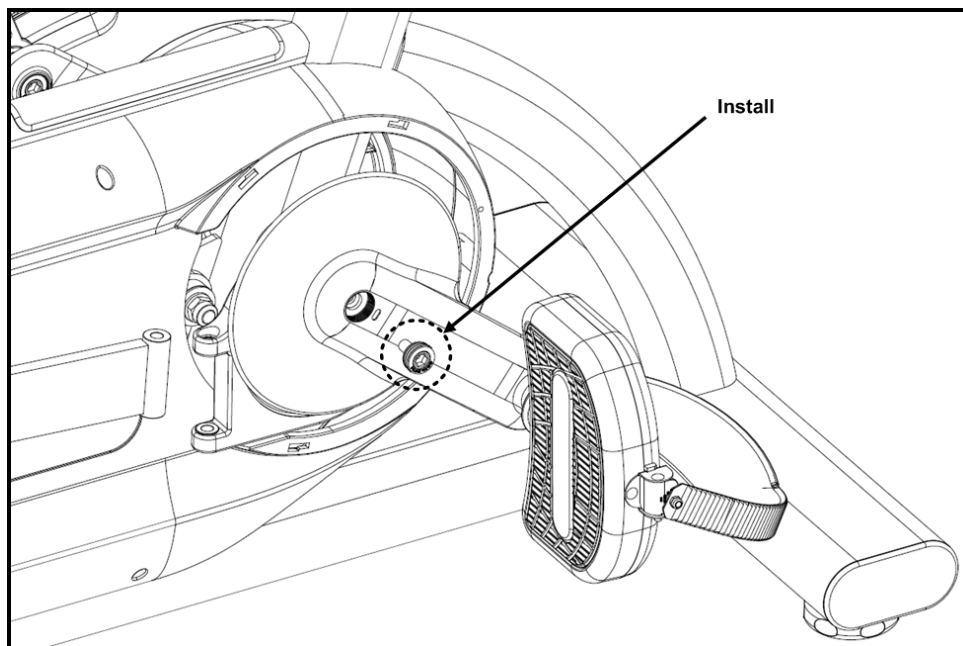

Fig. 7

8. Lock each crank arm to the bottom bracket by applying *Final Torque of: 33-37 Lb-Ft (45-50 Nm)* to each of the specialized securing socket head bolts (Fig. 8) using a torque wrench.

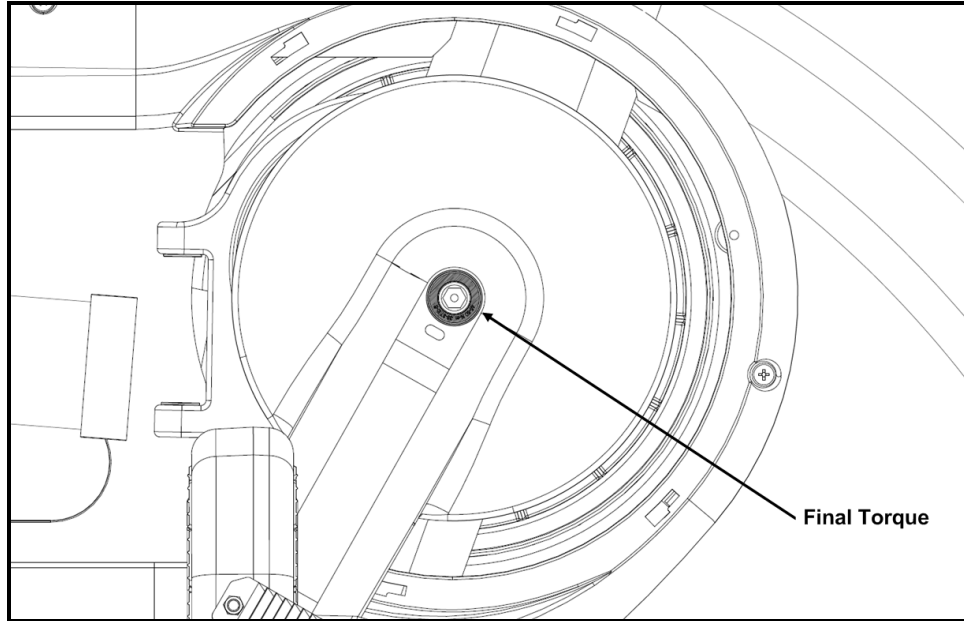

Fig. 8

9. To complete installation, reverse steps 2 & 1 of this process.